

THE COMMUNITY BASEMENT

Background

A number of projects need to be delivered on site before the Eisteddfod in 2010:

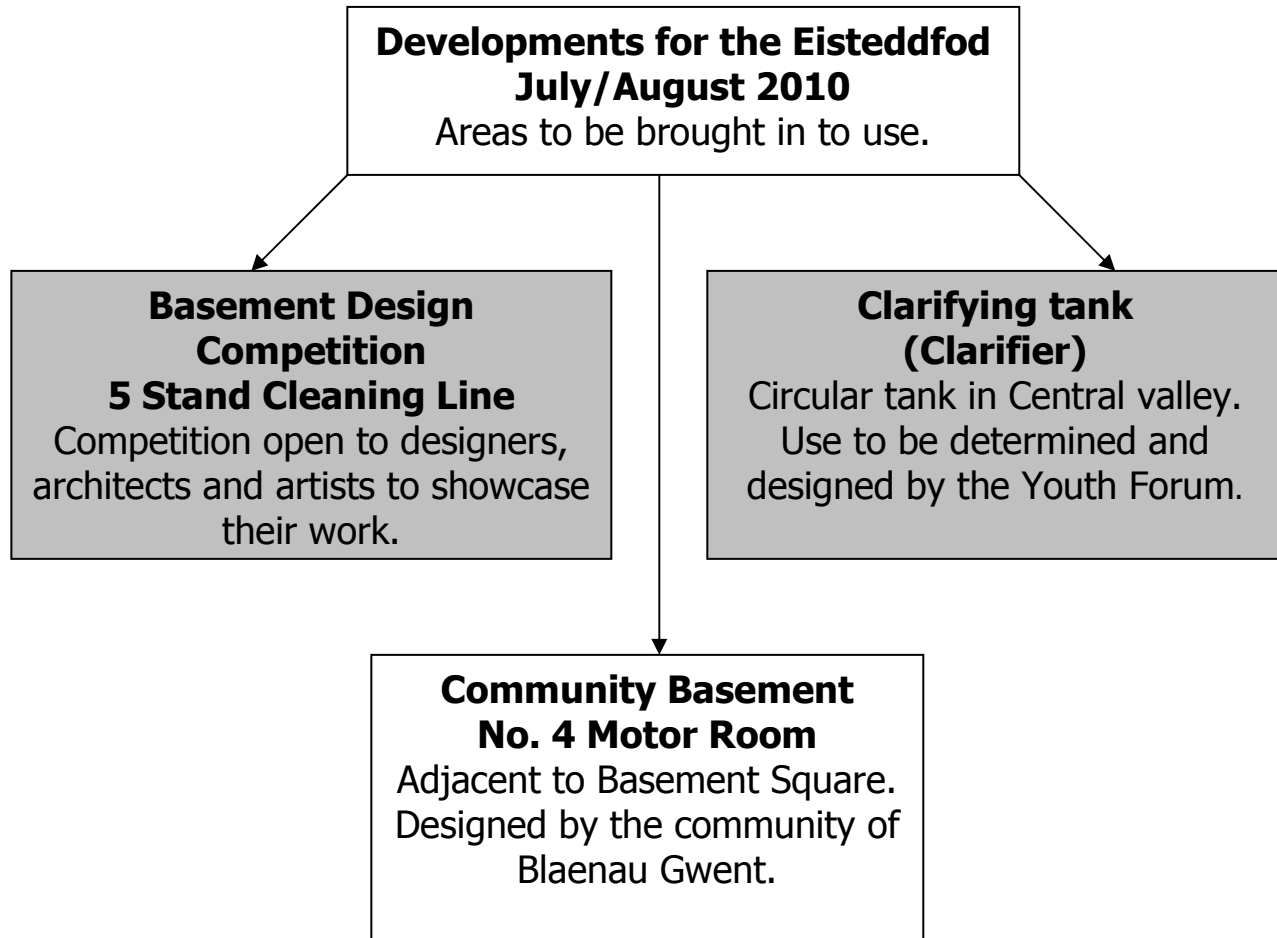

We would like an area at the Eisteddfod that represents the community and uses the No. 4 Motor Room basement. Groups from the community such as schools, community organisations and forums will be asked for ideas that will then be developed in detail with representatives of all groups.

What is No. 4 Motor Room?

It's one of the basements that have been kept after the site was cleaned up to remind us of the steelworks. No. 4 Motor Room used to house the huge motors and equipment that drove one of the cleaning processes for the steel.

Where is it?

It's on the Cold Mill area at the south side of Basement Park. It will be between the business area and sports pitches, near some housing.

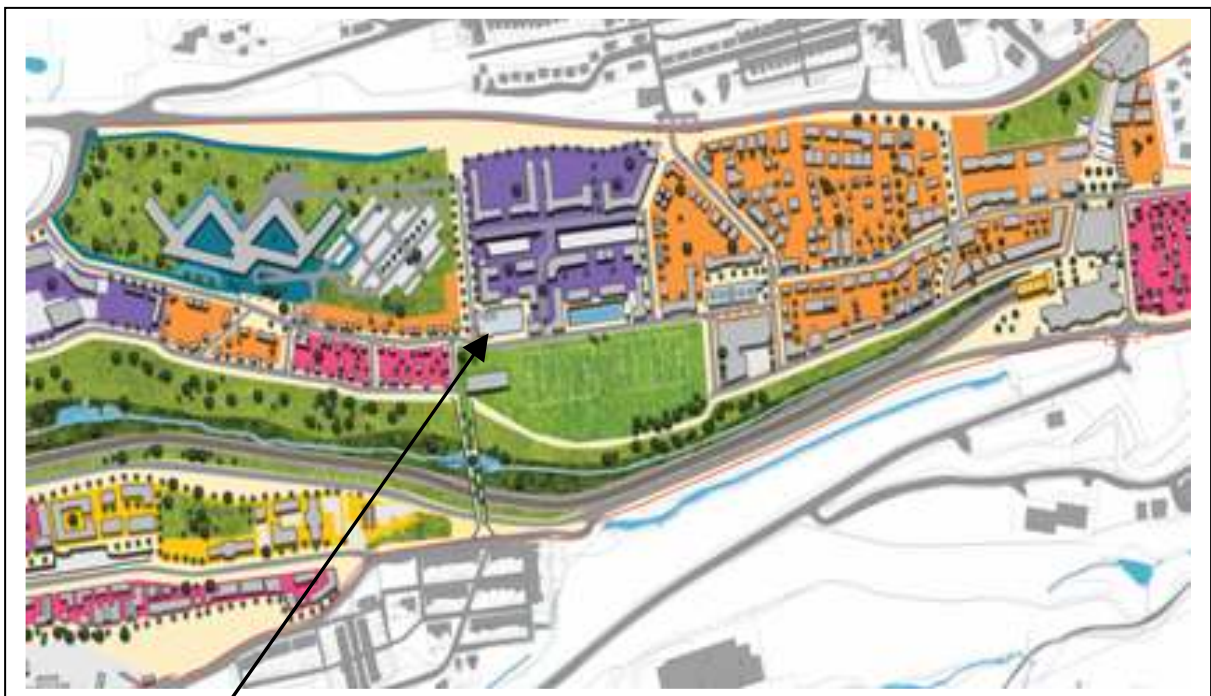

No. 4 Motor Room



No. 4 Motor Room, August 2008.

As the pictures show the site has changed and will continue to change over time. This design is for the Eisteddfod, then there may be some time when people can't access it, for example when building takes place nearby. The final use will change to give an area for young people as the site is finished.

How will the design be developed?

We'll talk to your group and collect your thoughts and ideas which will form the basis of several initial designs. We'll then invite two representatives of your group to join us and representatives of the other organisations involved to a site visit and session at the Project Office to develop the final design.

Things to bear in mind

- 🚧 Some ideas will get through, others won't, because of the budget, plans and systems we need to work with – we can't build an idea that will be dangerous for example.
- 🚧 We'll need to allow time to get planning permission and build the design.
- 🚧 It would be great if we could keep as many of the internal walls as possible.
- 🚧 The solution needs to be accessible to all.
- 🚧 It needs to be easy to maintain and look after.
- 🚧 The use of the area will change in the future.

Sustainability

We try to make everything at The Works as sustainable as possible under the headings below. The Community Basement will also need to follow these criteria.

- ✓ Achieve a Sustainable Economy – use local businesses and suppliers as far as possible.
- ✓ Social Progress – encouraging people to get involved in the site and encouraging them to visit
- ✓ Environmental Protection and Enhancement – to look after the natural and built environment and the history of The Works for future residents of Blaenau Gwent and visitors.
- ✓ Prudent Use of Resources – thinking about how we use materials and energy and promoting reuse and recycling in our developments.

Limitations

- Size and shape
- Safety
- Budget
- Master Plan – everything we do has to be within the Basement Strategy, part of the Master Plan. We can work together with some of our consultants to ensure that the final idea works.
- Planning. We have to apply for planning permission and have no guarantees we'll get it.

Stuck? Things to think about

- 🧱 Ideas that reflects the different communities in the county
- 🧱 Ideas that reflect the county itself: its history, geography and culture
- 🧱 Something that reminds people about the history of the steelworks and perhaps the materials that were produced.
- 🧱 Shapes of the Motor Room
- 🧱 Art work for the walls – mural/graffiti/mosaic
- 🧱 Planting
- 🧱 Shapes, colours, textures and materials

Any more thoughts and ideas?

Please contact me:

Helen Reardon, Projects Officer – Community Engagement

The Project Office, Steelworks Road, Ebbw Vale NP22 6AA

Tel: 01495 357810 or email helen.reardon@blaenau-gwent.gov.uk .